

Capturing viewport thumbnail takes too long (CTAv5.3)

If creating a thumbnail or a new camera takes too long due to screen grab calculations, make sure your display drivers are updated:

<https://www.nvidia.com/drivers/>.

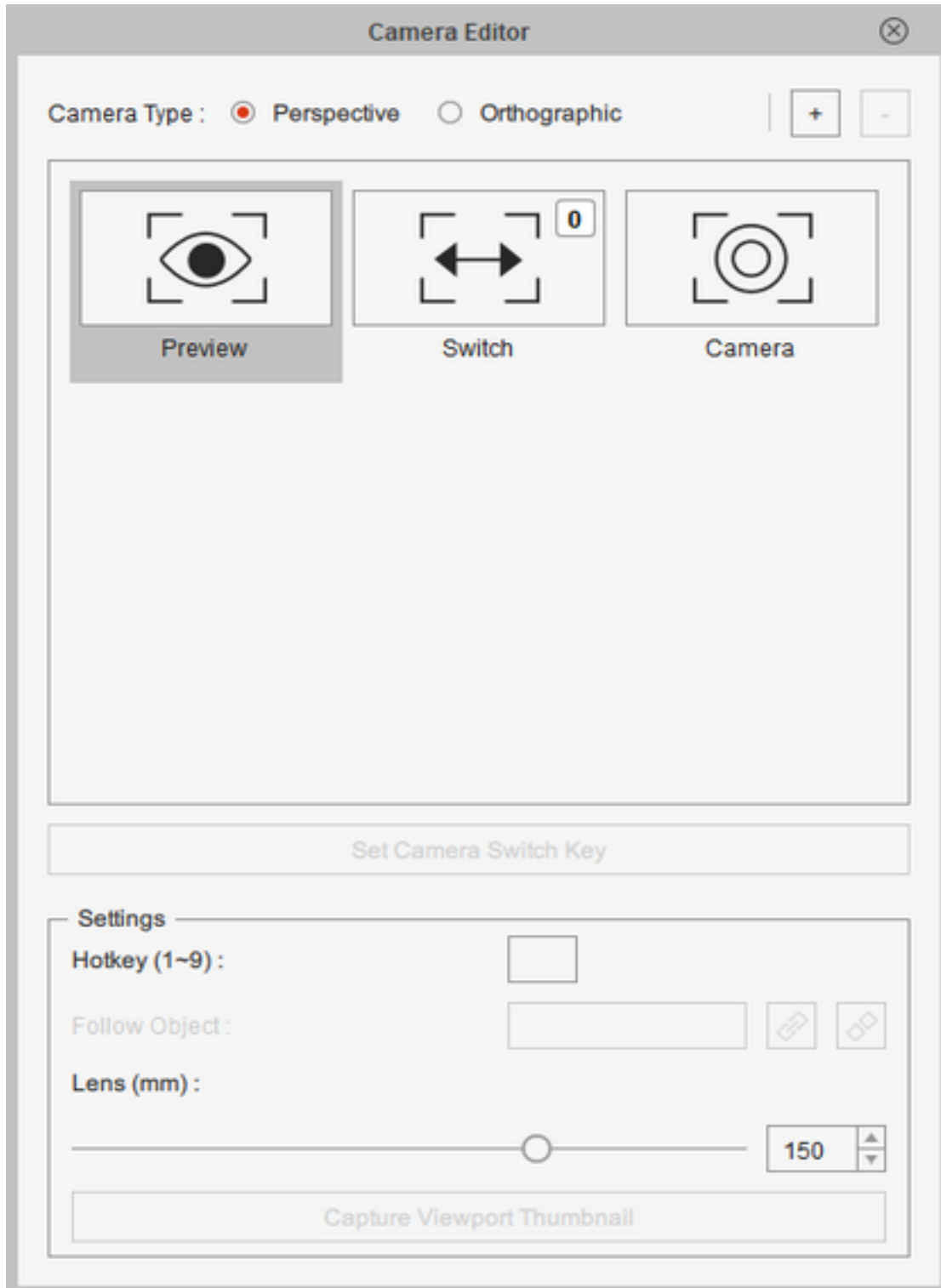

## Capturing viewport thumbnail takes too long (CTAv5.3)

Reallusion FAQ

<https://kb.reallusion.com/Product/53206/Capturing-viewport-thumbnail-takes-too-long-CTAv53>